

COMAU NUMBER	MODEL NUMBER	KVA @ 20% DC	KVA @ 50% DC	PRI VOLT/FREQ	V/SEC	TURNS RATIO	MAX. DELTA. P	FLOW RATE
-	TDC-6737-PED	158	100	500/1000	9.1	55:1	14 PSI (.96 BAR)	7.5 LPM
-	TDC-6738-PED	158	100	650/1000	9.0	72:1	14 PSI (.96 BAR)	7.5 LPM

COMMUNICATIONS BOX FOR: PROFI BUS

WATER CONNECTION  
30° MAX INLET TEMP.

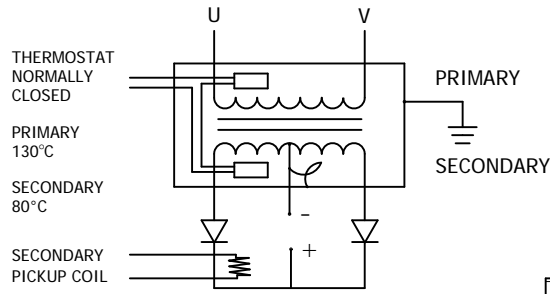

TRANSFORMER CASE MUST BE GROUNDED. TRANSFORMER WILL BE SHIPPED WITH AN INTERNAL JUMPER CONNECTING SECONDARY CENTER TAP TO CASE. USER MUST PROVIDE APPROPRIATE GROUNDING OF SECONDARY CIRCUIT. FOR APPLICATIONS ABOVE A 20% DUTY CYCLE, CONTACT ROMAN MANUFACTURING FOR ASSISTANCE.

NOTE\*  
The secondary terminals of this device are intended as an electrical connection only. Applications must be designed to minimize any forces applied to the secondary terminals, this can be accomplished by transferring forces to a structural member.

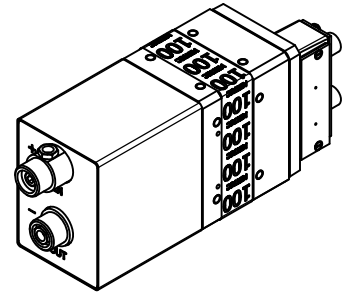
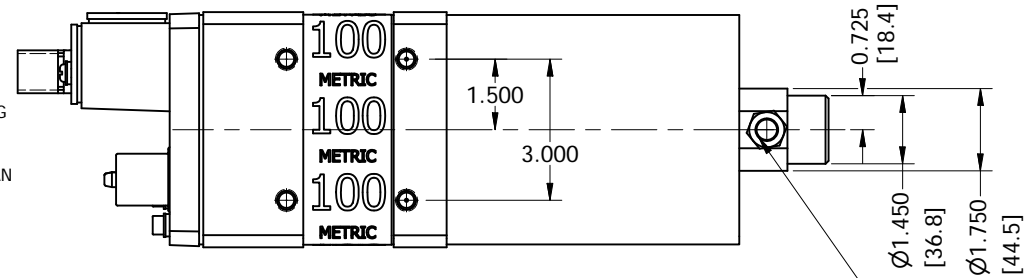

3/8-18 NPT - 1/4-18 NPT REDUCER BUSHING (2X)

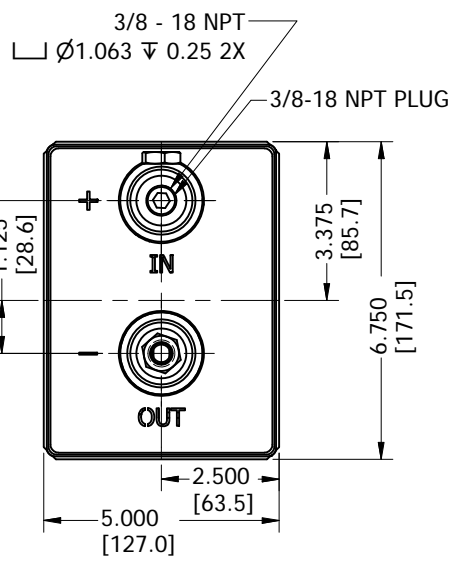
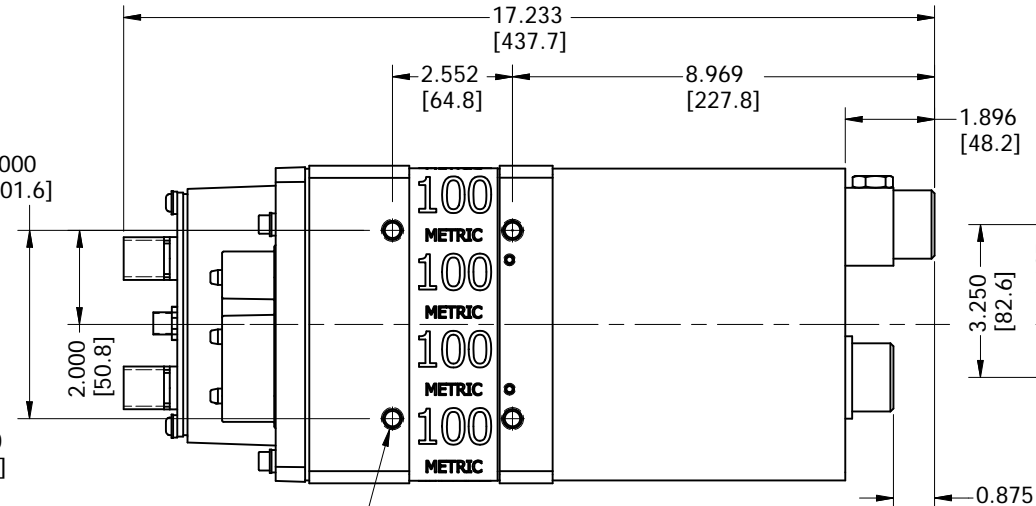
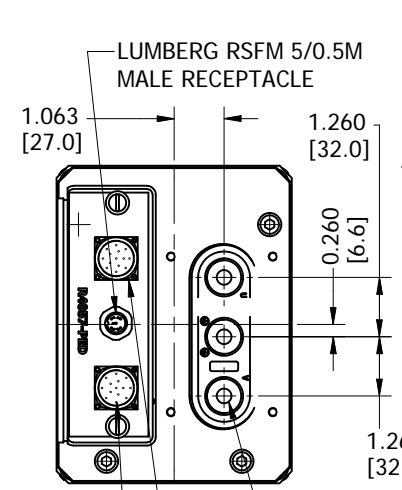

PRIMARY CONN. PINS (MULTI-CONTACT PLUG - S8/M8-57) TO BE PROVIDED BY RoMan  
PRIMARY CONN. PLUG (MULTI-CONTACT - RobiFix-B35-FZEE 30.4033") TO BE PROVIDED BY CUSTOMER

M10x1.5 HeliCoil - 6H  
15mm LG 16X

HYPERTEC SPHD17HFR0H260 FEMALE PLUG  
HYPERTEC SSFA17GMRSN000 MALE PLUG

APPROVED BY: \_\_\_\_\_  
DATE: \_\_\_\_\_

DIMENSIONS: IN[MM]

D	ADDED COMMUNICATIONS BOX FOR: PROFI BUS NOTE	JCB	KLY	2/13/2012
REV	DESCRIPTION	DATE		
THIS DRAWING AND ALL THE INFORMATION AND TECHNOLOGY IN IT ARE EXCLUSIVE, CONFIDENTIAL AND PROPRIETARY TO RoMan MFG. INC. THIS DRAWING IS OWNED BY RoMan MFG. INC. AND UNLESS SPECIFICALLY AUTHORIZED IN WRITING, NO COPIES SHALL BE MADE OF THIS DRAWING, AND SHALL BE USED ONLY FOR THE LIMITED PURPOSE FOR WHICH IT IS DISCLOSED AND ONLY TO THE BENEFIT OF RoMan MFG. INC., AND IT AND ANY COPIES, AUTHORIZED OR NOT, SHALL BE IMMEDIATELY RETURNED UPON ANY REQUEST THEREFORE.				
SCALE:	HALF	DRAWN BY:	DESSINK	
DATE:	1/21/2011	WEIGHT:	N/A	
<b>TRANSFORMER ASSEMBLY</b>				
PHYSICAL DRAWING				DRAWING NUMBER: <b>6737-1-PED</b>